

# Clay Point Associates, Inc.

[www.claypointassociates.com](http://www.claypointassociates.com)



January 22, 2024

Andrea Pedersen  
Montrose Environmental  
5120 Northshore Drive  
North Little Rock, Arkansas 72118

Re: Report of Limited Lead-Based Paint Inspection  
Greensboro Town Offices, 82 Craftsbury Road, Greensboro, Vermont  
CPAI Project #16015

Dear Ms. Pederson:

Enclosed for your review is the Clay Point Associates, Inc. (CPAI) report describing the limited lead-based paint inspection performed on January 16, 2024, on/within the Town Offices at 82 Craftsbury Road, Greensboro, Vermont. The inspection was performed in accordance with the guidelines outlined in Chapter 7: Lead-Based Paint Inspection of the U.S. Department of Housing and Urban Development's, "Guidelines for the Evaluation and Control of Lead-Based Paint Hazards in Housing", July 2012 revision (HUD). Inspection activities were performed on the Interior First and Third Floors and the building Exterior. The Second Floor had been previously evaluated by others and was not inspected by CPAI.

For your information, lead-based paint was detected on/within the structure.

On-site testing was performed by use of a portable X-Ray Fluorescence Analyzer (XRF). Specifically, a Viken Detection (Heuresis) Pb200i Handheld XRF Lead Paint Analyzer, serial number #2074, was used by CPAI to inspect all accessible painted/stained surfaces. The XRF calibration was checked according to the manufacturer's recommendations and the guidelines outlined in the December 1, 2015, Performance Characteristic Sheet (PCS) for the above referenced instrument. In addition, precautionary measures were taken to ensure that building occupants, inspectors, and escorts were not inadvertently exposed to radiation because of testing.

Attached are the "Lead-Based Paint Testing Data Sheets" generated during the inspection. The sheets reference locations in each room/area where representative XRF testing was performed. Walls in each room/area were assigned an A, B, C or D letter notation. The A Wall in each room/area is always at the street side of the building (Craftsbury Road). Notations then proceed clockwise from the A wall to the B, C and D walls. If more than one door or window is on one wall, the #1 door/ window is always on the inspector's left as s/he faces the wall. Notations then proceed left to right from 1, to 2, to 3, etc. Also attached please find "Lead Survey Building Sketches" which provide room/area numbers and descriptions of each room's use (i.e., Kitchens, Bathrooms, Bedrooms, etc.).

XRF readings are classified into two categories: positive (lead-based paint) and negative (not defined as lead-based paint). The appropriate category is noted in the far-right column on the Lead-Based Paint Testing Data Sheets. The Vermont Regulations For Lead Control, V.S.A. Title 18, Chapter 38, Effective October 2, 1994, amended May 1, 2001, defines Lead-Based Paint in target housing and daycare facilities as "paint or other surface coatings that contain lead in excess of 1.0 mg/sq. cm. or 0.5 percent by weight (5,000 ppm), or (1) in the case of paint or other surface coatings such lower level as may be established by the Secretary of Housing and Urban Development, as defined by Section 302 (c) of the Lead Based Paint Poisoning Prevention Act, or (2) in the case of any other paint or surface coatings, such other level as may be established by the Administrator of EPA." The Vermont Occupational Safety and Health Administration (VOSHA) does not specify a regulated quantity of lead within paint. Applicable VOSHA regulations address the presence of lead within paint regardless of specific quantity present.

Please note that this document does not provide a comprehensive inventory of components with lead-based paint. This is because protocols do not require testing of every inch of a painted/ stained surface.

Components with the same paint history as those tested may contain lead-based paint within each room or on the building exterior (i.e., under the currently visible paint layer). In addition, protocols do not require testing of more than one item from the same testing component within each room (i.e., if more than one window was present in a room, and if CPAI tested window components from one window and they were positive, then the same window components from the other windows in the room should be assumed to be positive).

Please be aware that in accordance with HUD and the U.S. Environmental Protection Agency (EPA) guidelines (24 CFR Part 35 and 40 CFR Part 745) a copy of this report must be provided to new lessees (tenants) and purchasers of this property before they become obligated under a lease or sales contract. The complete report must also be made available to current and future tenants (if applicable). Landlords (lessors) and sellers are also required to distribute an educational pamphlet approved by the U.S. EPA and include standard warning language in their leases or sales contracts to ensure that parents have the information they need to protect their children from lead-based paint hazards.

All lead-based paint inspection activities were performed by Christer Herrmans. Mr. Herrmans is a State of Vermont certified Lead Inspector & Risk Assessor (Lead-I/RA-000011). Specific hours of on-site testing are available upon request.

Andrea Pedersen  
January 22, 2024  
Page 2

Thank you for the opportunity to service your professional environmental management needs. If you have any questions concerning this inspection report, or require additional services, please contact us at (802) 879-2600.

Sincerely,  
CLAY POINT ASSOCIATES, INC.

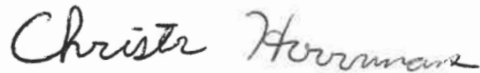
A handwritten signature in cursive script that reads "Christer Herrmans". The signature is written in dark ink on a light-colored background.

Christer Herrmans  
Environmental Specialist

# FIRST FLOOR

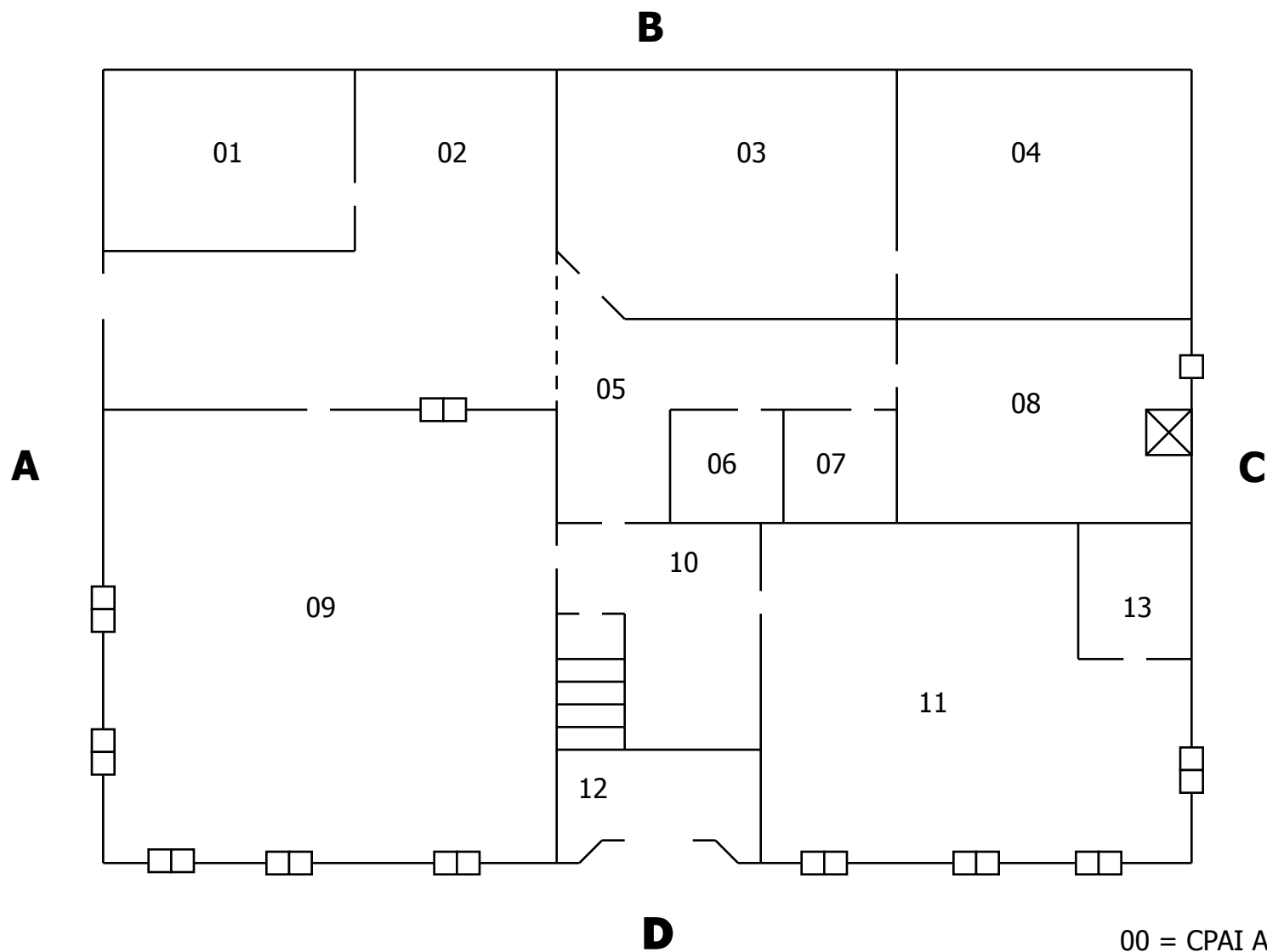

Clay Point Associates, Inc.  
Project #16015  
January 16, 2024

Greensboro Town Offices  
82 Craftsbury Road  
Greensboro, Vermont

Lead Based Paint Inspection  
Not to Scale  
Drawn by: Christer Herrmans

## THIRD FLOOR

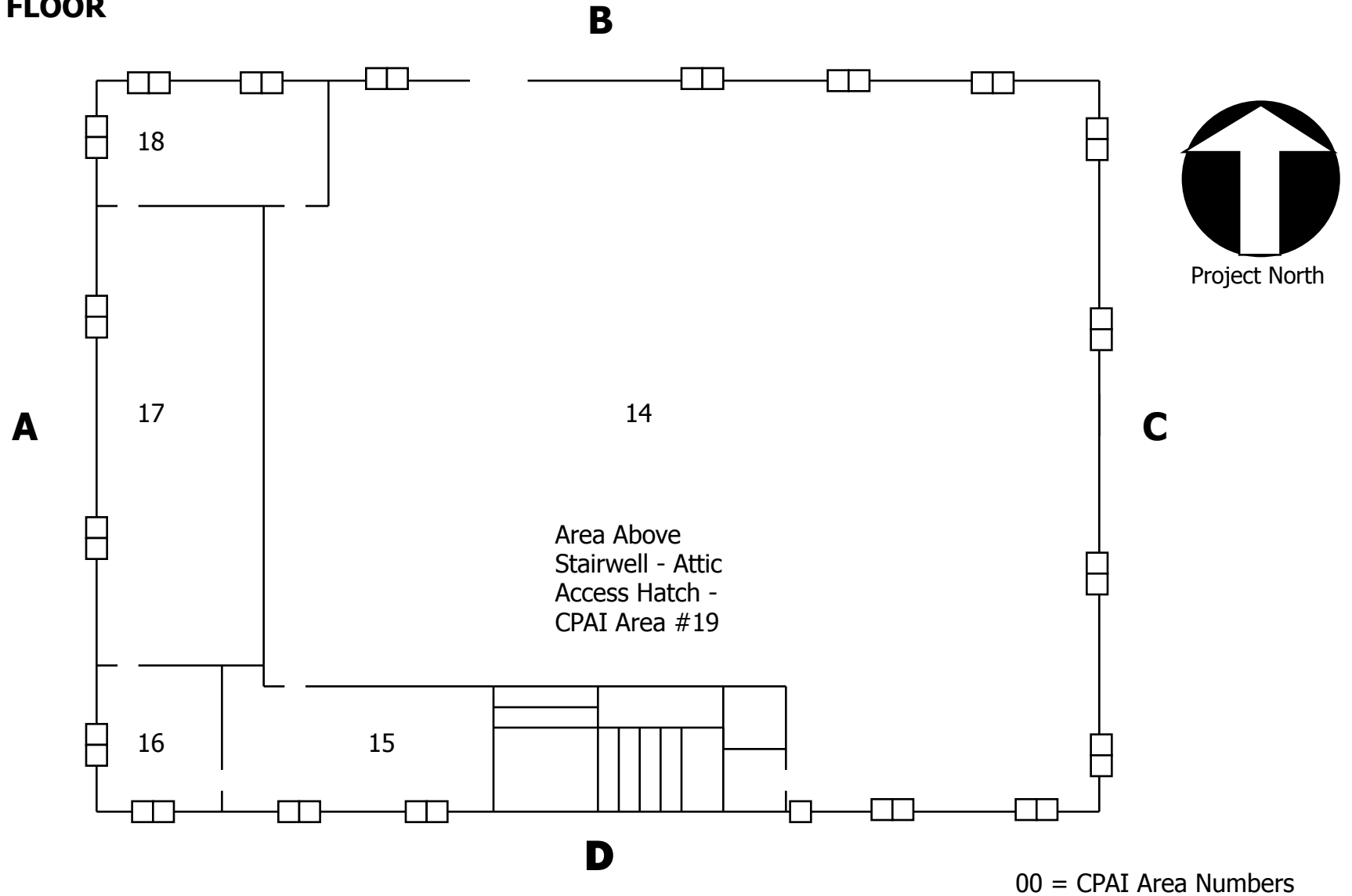

Clay Point Associates, Inc.  
Project #16015  
January 16, 2024

Greensboro Town Offices  
82 Craftsbury Road  
Greensboro, Vermont

Lead Based Paint Inspection  
Not to Scale  
Drawn by: Christer Herrmans



## Calibration Check Test Results

ADDRESS: 82 Craftsbury Road  
Greensboro, Vermont

DATE: 01/16/23  
INSPECTOR: Christer Herrmans  
XRF SERIAL NO.: 2074

Start Calibration Check, 1.04 mg/cm <sup>2</sup> (Standard Block)		
Time:	Reading:	Calibration (mg./sq. cm.):
09:00	01	1.0
	02	1.0
	03	1.0
	Average:	1.0

Start Calibration Check, <0.001 mg/cm <sup>2</sup> (Standard Block)		
Time:	Reading:	Calibration (mg./sq. cm.):
09:02	04	0.1
	05	0.1
	06	0.1
	Average:	0.1

Start Calibration Check, 1.04 mg/cm <sup>2</sup> (Standard Block)		
Time:	Reading:	Calibration (mg./sq. cm.):
12:45	360	1.0
	361	1.0
	362	1.0
	Average:	1.0

Start Calibration Check, <0.001 mg/cm <sup>2</sup> (Standard Block)		
Time:	Reading:	Calibration (mg./sq. cm.):
12:47	363	0.1
	364	0.0
	365	0.1
	Average:	0.1

Calibration Check Tolerance Used **1.0 mg./sq. cm.**  
XRF Calibration Check Limits: 0.7 mg./sq. cm. to 1.3 mg./sq. cm. (inclusive)

Inspector Signature: Christer Herrmans

# LEAD BASED PAINT TESTING DATA SHEET



**Clay Point Associates, Inc.**  
P.O. Box 1254, Williston, VT 05495  
(802) 879-2600

ADDRESS: 82 Craftsbury Road, Greensboro, Vermont Greensboro Town Offices

DATE: January 16, 2024

XRF SERIAL NO.: 2074

ROOM EQUIVALENT: 01

INSPECTOR: Christer Herrmans

READING	COMPONENT	COLOR	SUBSTRATE	COND.	TEST LOCATION/DESCRIPTION	XRF READING (mg/sq. cm)	CLASS
07	Ceiling	White	Concrete	Intact		0.2	Neg.
08	Door	Grey	Metal	Intact	Wall C, Door 1	0.1	Neg.
09	Door Casing	Grey	Metal	Intact	Wall C, Door 1	0.0	Neg.
10	Threshold	Grey	Metal	Intact	Wall C, Door 1	0.1	Neg.
11	Wall	White	CMU	Intact	Wall A	0.1	Neg.
12	Wall	White	CMU	Intact	Wall B	0.0	Neg.
13	Wall	White	CMU	Intact	Wall C	0.0	Neg.
14	Wall	White	CMU	Intact	Wall D	0.0	Neg.

— Baseboard is covebase.

— Floor is vinyl floor tile.

# LEAD BASED PAINT TESTING DATA SHEET



**Clay Point Associates, Inc.**  
P.O. Box 1254, Williston, VT 05495  
(802) 879-2600

ADDRESS: 82 Craftsbury Road, Greensboro, Vermont Greensboro Town Offices

DATE: January 16, 2024

XRF SERIAL NO.: 2074

ROOM EQUIVALENT: 02

INSPECTOR: Christer Herrmans

READING	COMPONENT	COLOR	SUBSTRATE	COND.	TEST LOCATION/DESCRIPTION	XRF READING (mg/sq. cm)	CLASS
15	Door	Black	Metal	Intact	Wall A, Door 1	0.1	Neg.
16	Door Casing	Black	Metal	Intact	Wall A, Door 1	0.2	Neg.
17	Door	Grey	Metal	Intact	Wall A, Door 2	0.0	Neg.
18	Door Casing	Grey	Metal	Intact	Wall A, Door 2	0.0	Neg.
19	Door	Stained	Wood	Intact	Wall D, Door 1	0.1	Neg.
20	Door Casing	White	Metal	Intact	Wall D, Door 1	0.0	Neg.
21	Window Casing	White	Metal	Intact	Wall D, Window 1 (to CPAI Area #09)	0.1	Neg.
22	Shelf	Grey	Wood	Intact	Wall D	0.0	Neg.
23	Radiator	Beige	Metal	Intact	Wall B	0.0	Neg.
24	Support Column	White	Sheet Rock	Intact	Middle of Room	0.0	Neg.
25	Wall	White	Sheet Rock	Intact	Wall A	0.1	Neg.
26	Wall	White	Sheet Rock	Intact	Wall B	0.1	Neg.
27	Wall	White	Sheet Rock	Intact	Wall C	0.1	Neg.
28	Wall	White	Sheet Rock	Intact	Wall D	0.1	Neg.

- Ceiling is suspended ceiling tile.
- Wall C Opening has no painted components.
- Window D-2 (to CPAI Area #09) components are the same as Window D-1.
- Baseboard is covebase.
- Floor is vinyl floor tile.



# LEAD BASED PAINT TESTING DATA SHEET



**Clay Point Associates, Inc.**  
P.O. Box 1254, Williston, VT 05495  
(802) 879-2600

ADDRESS: 82 Craftsbury Road, Greensboro, Vermont      Greensboro Town Offices

DATE: January 16, 2024

XRF SERIAL NO.: 2074

ROOM EQUIVALENT: 03

INSPECTOR: Christer Herrmans

READING	COMPONENT	COLOR	SUBSTRATE	COND.	TEST LOCATION/DESCRIPTION	XRF READING (mg/sq. cm)	CLASS
29	Ceiling	White	Sheet Rock	Intact		0.1	Neg.
30	Door	Stained	Wood	Intact	Wall A, Door 1	0.0	Neg.
31	Door Casing	Grey	Metal	Intact	Wall A, Door 1	0.1	Neg.
32	Door Jamb	White	Metal	Intact	Wall A, Door 1	0.0	Neg.
33	Door	Stained	Wood	Intact	Wall C, Door 1	0.0	Neg.
34	Door Casing	Stained	Wood	Intact	Wall C, Door 1	0.0	Neg.
35	Door Stop	Stained	Wood	Intact	Wall C, Door 1	0.0	Neg.
36	Support Column	White	Metal	Intact	Middle of Room	0.5	Neg.
37	Wall	Blue	Sheet Rock	Intact	Wall A	0.1	Neg.
38	Wall	Blue	Concrete	Intact	Wall B	0.0	Neg.
39	Wall	Blue	Sheet Rock	Intact	Wall C	0.1	Neg.
40	Wall	Blue	Sheet Rock	Intact	Wall D	0.1	Neg.
41	Floor	Blue	Concrete	Intact		0.3	Neg.

— Door A-2 components are the same as Door A-1 (double door).

# LEAD BASED PAINT TESTING DATA SHEET



**Clay Point Associates, Inc.**  
P.O. Box 1254, Williston, VT 05495  
(802) 879-2600

ADDRESS: 82 Craftsbury Road, Greensboro, Vermont      Greensboro Town Offices

DATE: January 16, 2024

XRF SERIAL NO.: 2074

ROOM EQUIVALENT: 04

INSPECTOR: Christer Herrmans

READING	COMPONENT	COLOR	SUBSTRATE	COND.	TEST LOCATION/DESCRIPTION	XRF READING (mg/sq. cm)	CLASS
42	Door	Stained	Wood	Intact	Wall A, Door 1	0.0	Neg.
43	Door Casing	Stained	Wood	Intact	Wall A, Door 1	0.1	Neg.
44	Door Jamb	Stained	Wood	Intact	Wall A, Door 1	0.1	Neg.
45	Support Column	Brown	Metal	Deter.	Middle of Room	0.6	Neg.

— All other components are unpainted.

# LEAD BASED PAINT TESTING DATA SHEET



**Clay Point Associates, Inc.**  
P.O. Box 1254, Williston, VT 05495  
(802) 879-2600

ADDRESS: 82 Craftsbury Road, Greensboro, Vermont Greensboro Town Offices

DATE: January 16, 2024

XRF SERIAL NO.: 2074

ROOM EQUIVALENT: 05

INSPECTOR: Christer Herrmans

READING	COMPONENT	COLOR	SUBSTRATE	COND.	TEST LOCATION/DESCRIPTION	XRF READING (mg/sq. cm)	CLASS
46	Door	Stained	Wood	Intact	Wall C, Door 1 (to CPAI Area #03)	0.0	Neg.
47	Door Casing	White	Metal	Intact	Wall C, Door 1 (to CPAI Area #03)	0.0	Neg.
48	Door	Stained	Wood	Intact	Wall C, Door 3 (to CPAI Area #08)	0.1	Neg.
49	Door Casing	White	Metal	Intact	Wall C, Door 3 (to CPAI Area #08)	0.0	Neg.
50	Door	Stained	Wood	Intact	Wall D, Door 1	0.0	Neg.
51	Door Casing	White	Metal	Intact	Wall D, Door 1	0.0	Neg.
52	Door	Stained	Wood	Intact	Wall D, Door 3	0.0	Neg.
53	Door Casing	Stained	Wood	Intact	Wall D, Door 3	0.1	Neg.
54	Door Jamb	Stained	Wood	Intact	Wall D, Door 3	0.2	Neg.
55	Shelf	White	Wood	Intact	Wall A	0.1	Neg.
56	Shelf Support	White	Wood	Intact	Wall A	0.0	Neg.
57	Wall	White	Sheet Rock	Intact	Wall A	0.0	Neg.
58	Wall	White	Sheet Rock	Intact	Wall B	0.0	Neg.
59	Wall	White	Sheet Rock	Intact	Wall C	0.0	Neg.
60	Wall	White	Sheet Rock	Intact	Wall D	0.0	Neg.
61	Wall	Stained	Wood	Intact	Wall D (near Door D-3)	0.0	Neg.

# LEAD BASED PAINT TESTING DATA SHEET



**Clay Point Associates, Inc.**  
P.O. Box 1254, Williston, VT 05495  
(802) 879-2600

ADDRESS: 82 Craftsbury Road, Greensboro, Vermont      Greensboro Town Offices

DATE: January 16, 2024

XRF SERIAL NO.: 2074

ROOM EQUIVALENT: 05 (cont.)

INSPECTOR: Christer Herrmans

READING	COMPONENT	COLOR	SUBSTRATE	COND.	TEST LOCATION/DESCRIPTION	XRF READING (mg/sq. cm)	CLASS
<p>— Ceiling is suspended ceiling tile.</p> <p>— Door C-2 components are the same as Door C-1 (double door).</p> <p>— Door D-2 components are the same as Door D-1.</p> <p>— Baseboard is covebase.</p> <p>— Floor is vinyl floor tile.</p>							

# LEAD BASED PAINT TESTING DATA SHEET



**Clay Point Associates, Inc.**  
P.O. Box 1254, Williston, VT 05495  
(802) 879-2600

ADDRESS: 82 Craftsbury Road, Greensboro, Vermont      Greensboro Town Offices

DATE: January 16, 2024

XRF SERIAL NO.: 2074

ROOM EQUIVALENT: 06

INSPECTOR: Christer Herrmans

READING	COMPONENT	COLOR	SUBSTRATE	COND.	TEST LOCATION/DESCRIPTION	XRF READING (mg/sq. cm)	CLASS
62	Door	Stained	Wood	Intact	Wall B, Door 1	0.0	Neg.
63	Door Casing	White	Metal	Intact	Wall B, Door 1	0.1	Neg.
64	Wall	White	Sheet Rock	Intact	Wall A	0.0	Neg.
65	Wall	White	Sheet Rock	Intact	Wall B	0.0	Neg.
66	Wall	White	Sheet Rock	Intact	Wall C	0.1	Neg.
67	Wall	White	Sheet Rock	Intact	Wall D	0.0	Neg.
68	Support Column	White	Sheet Rock	Intact	Middle of Room	0.0	Neg.

- Ceiling is suspended ceiling tile.
- Baseboard is covebase.
- Floor is linoleum floor covering.

# LEAD BASED PAINT TESTING DATA SHEET



**Clay Point Associates, Inc.**  
P.O. Box 1254, Williston, VT 05495  
(802) 879-2600

ADDRESS: 82 Craftsbury Road, Greensboro, Vermont      Greensboro Town Offices

DATE: January 16, 2024

XRF SERIAL NO.: 2074

ROOM EQUIVALENT: 07

INSPECTOR: Christer Herrmans

READING	COMPONENT	COLOR	SUBSTRATE	COND.	TEST LOCATION/DESCRIPTION	XRF READING (mg/sq. cm)	CLASS
69	Door	Stained	Wood	Intact	Wall B, Door 1	0.1	Neg.
70	Door Casing	White	Metal	Intact	Wall B, Door 1	0.0	Neg.
71	Radiator	Beige	Metal	Intact	Wall D	0.0	Neg.
72	Wall	White	Sheet Rock	Intact	Wall A	0.1	Neg.
73	Wall	White	Sheet Rock	Intact	Wall B	0.1	Neg.
74	Wall	White	Sheet Rock	Intact	Wall C	0.1	Neg.
75	Wall	White	Sheet Rock	Intact	Wall D	0.1	Neg.

- Ceiling is suspended ceiling tile.
- Baseboard is covebase.
- Floor is linoleum floor covering.

# LEAD BASED PAINT TESTING DATA SHEET



**Clay Point Associates, Inc.**  
P.O. Box 1254, Williston, VT 05495  
(802) 879-2600

ADDRESS: 82 Craftsbury Road, Greensboro, Vermont      Greensboro Town Offices

DATE: January 16, 2024

XRF SERIAL NO.: 2074

ROOM EQUIVALENT: 08

INSPECTOR: Christer Herrmans

READING	COMPONENT	COLOR	SUBSTRATE	COND.	TEST LOCATION/DESCRIPTION	XRF READING (mg/sq. cm)	CLASS
76	Door	Stained	Wood	Intact	Wall A, Door 1	0.1	Neg.
77	Door Casing	Grey	Metal	Intact	Wall A, Door 1	0.1	Neg.
78	Casing	Stained	Wood	Intact	Wall A, Door 1	0.1	Neg.
79	Support Column	Black	Metal	Intact	Middle of Room	0.1	Neg.
80	Support Column	Brown	Metal	Intact	Middle of Room	0.5	Neg.

— All other components are unpainted.

# LEAD BASED PAINT TESTING DATA SHEET



**Clay Point Associates, Inc.**  
P.O. Box 1254, Williston, VT 05495  
(802) 879-2600

ADDRESS: 82 Craftsbury Road, Greensboro, Vermont Greensboro Town Offices

DATE: January 16, 2024

XRF SERIAL NO.: 2074

ROOM EQUIVALENT: 09

INSPECTOR: Christer Herrmans

READING	COMPONENT	COLOR	SUBSTRATE	COND.	TEST LOCATION/DESCRIPTION	XRF READING (mg/sq. cm)	CLASS
81	Door	Stained	Wood	Intact	Wall C, Door 1	0.0	Neg.
82	Door Casing	White	Metal	Intact	Wall C, Door 1	0.1	Neg.
83	Door	Stained	Wood	Intact	Wall B, Door 1	0.0	Neg.
84	Door Casing	White	Metal	Intact	Wall B, Door 1	0.0	Neg.
85	Window Casing	White	Wood	Intact	Wall A, Window 1	0.0	Neg.
86	Window Sash	White	Wood	Intact	Wall A, Window 1	0.1	Neg.
87	Window Casing	Stained	Wood	Intact	Wall D, Window 1	0.0	Neg.
88	Window Sash	Stained	Wood	Intact	Wall D, Window 1	0.0	Neg.
89	Window Casing	White	Metal	Intact	Wall B, Window 1	0.1	Neg.
90	Support Column	White	Sheet Rock	Intact	Middle of Room	0.1	Neg.
91	Wall	White	Sheet Rock	Intact	Wall A	0.1	Neg.
92	Wall	White	Sheet Rock	Intact	Wall B	0.1	Neg.
93	Wall	White	Sheet Rock	Intact	Wall C	0.1	Neg.
94	Wall	White	Sheet Rock	Intact	Wall D	0.1	Neg.
95	Radiator	Beige	Metal	Intact	Wall D	0.1	Neg.
96	Shelf	Grey	Wood	Intact	Wall B	0.1	Neg.



# LEAD BASED PAINT TESTING DATA SHEET



**Clay Point Associates, Inc.**  
P.O. Box 1254, Williston, VT 05495  
(802) 879-2600

ADDRESS: 82 Craftsbury Road, Greensboro, Vermont      Greensboro Town Offices

DATE: January 16, 2024

XRF SERIAL NO.: 2074

ROOM EQUIVALENT: 09 (cont.)

INSPECTOR: Christer Herrmans

READING	COMPONENT	COLOR	SUBSTRATE	COND.	TEST LOCATION/DESCRIPTION	XRF READING (mg/sq. cm)	CLASS
<ul style="list-style-type: none"><li>— Ceiling is suspended ceiling tile.</li><li>— Windows A-2, A-3 and A-4 components are the same as Window A-1.</li><li>— Windows D-2, D-3, D-4, D-5 and D-6 components are the same as Window D-1.</li><li>— Window B-2 components are the same as Window B-1.</li><li>— Baseboard is covebase.</li><li>— Floor is carpet.</li></ul>							

# LEAD BASED PAINT TESTING DATA SHEET



**Clay Point Associates, Inc.**  
P.O. Box 1254, Williston, VT 05495  
(802) 879-2600

ADDRESS: 82 Craftsbury Road, Greensboro, Vermont Greensboro Town Offices

DATE: January 16, 2024

XRF SERIAL NO.: 2074

ROOM EQUIVALENT: 10

INSPECTOR: Christer Herrmans

READING	COMPONENT	COLOR	SUBSTRATE	COND.	TEST LOCATION/DESCRIPTION	XRF READING (mg/sq. cm)	CLASS
97	Door	Stained	Wood	Intact	Wall A, Door 1	0.1	Neg.
98	Door Casing	White	Metal	Intact	Wall A, Door 1	0.0	Neg.
99	Door	Stained	Wood	Intact	Wall B, Door 1	0.0	Neg.
100	Door Casing	Stained	Wood	Intact	Wall B, Door 1	0.0	Neg.
101	Door Stop	Stained	Wood	Intact	Wall B, Door 1	0.0	Neg.
102	Door	Stained	Wood	Intact	Wall C, Door 1	0.1	Neg.
103	Door Casing	White	Wood	Intact	Wall C, Door 1	0.1	Neg.
104	Door Jamb	White	Wood	Intact	Wall C, Door 1	0.0	Neg.
105	Cabinet	White	Wood	Intact	Wall A	0.0	Neg.
106	Cabinet	Green	Wood	Intact	Wall A	22.8	<b>POS.</b>
107	Wall	White	Sheet Rock	Intact	Wall A	0.0	Neg.
108	Wall	White	Sheet Rock	Intact	Wall B	0.0	Neg.
109	Wall	White	Sheet Rock	Intact	Wall C	0.0	Neg.
110	Wall	White	Sheet Rock	Intact	Wall D	0.0	Neg.
112	Wall	Stained	Wood	Intact	Wall B (near Door B-1)	0.0	Neg.

- Ceiling is suspended ceiling tile.
- Door D-1 components are the same as Door A-1.
- Baseboard is covebase.
- Floor is vinyl floor tile.

# LEAD BASED PAINT TESTING DATA SHEET



**Clay Point Associates, Inc.**  
P.O. Box 1254, Williston, VT 05495  
(802) 879-2600

ADDRESS: 82 Craftsbury Road, Greensboro, Vermont      Greensboro Town Offices

DATE: January 16, 2024

XRF SERIAL NO.: 2074

ROOM EQUIVALENT: 11

INSPECTOR: Christer Herrmans

READING	COMPONENT	COLOR	SUBSTRATE	COND.	TEST LOCATION/DESCRIPTION	XRF READING (mg/sq. cm)	CLASS
113	Door	White	Wood	Intact	Wall A, Door 1	0.0	Neg.
114	Door Casing	White	Wood	Intact	Wall A, Door 1	0.1	Neg.
115	Door Stop	White	Wood	Intact	Wall A, Door 1	0.0	Neg.
116	Door	Grey	Metal	Intact	Wall B, Door 1	0.0	Neg.
117	Door Casing	Grey	Metal	Intact	Wall B, Door 1	0.0	Neg.
118	Threshold	Grey	Metal	Intact	Wall B, Door 1	0.1	Neg.
119	Window Casing	Stained	Wood	Intact	Wall D, Window 1	0.0	Neg.
120	Window Sash	Stained	Wood	Intact	Wall D, Window 1	0.0	Neg.
121	Window Casing	White	Wood	Intact	Wall C, Window 1	0.0	Neg.
122	Window Sash	White	Wood	Intact	Wall C, Window 1	0.0	Neg.
123	Door Casing	White	Wood	Intact	Wall B, Door 1 (outer)	0.2	Neg.
124	Support Column	White	Metal	Intact	Middle of Room	0.1	Neg.
125	Wall	White	Sheet Rock	Intact	Wall A	0.1	Neg.
126	Wall	White	Sheet Rock	Intact	Wall B	0.1	Neg.
127	Wall	White	Sheet Rock	Intact	Wall C	0.1	Neg.
128	Wall	White	Sheet Rock	Intact	Wall D	0.1	Neg.
129	Baseboard	White	Wood	Intact	Wall A	0.0	Neg.
130	Radiator	Beige	Metal	Intact	Wall D	0.0	Neg.
131	Floor	Brown	Concrete	Intact		0.2	Neg.

# LEAD BASED PAINT TESTING DATA SHEET



**Clay Point Associates, Inc.**  
P.O. Box 1254, Williston, VT 05495  
(802) 879-2600

ADDRESS: 82 Craftsbury Road, Greensboro, Vermont      Greensboro Town Offices

DATE: January 16, 2024

XRF SERIAL NO.: 2074

ROOM EQUIVALENT: 11 (cont.)

INSPECTOR: Christer Herrmans

READING	COMPONENT	COLOR	SUBSTRATE	COND.	TEST LOCATION/DESCRIPTION	XRF READING (mg/sq. cm)	CLASS
<p>— Ceiling is suspended ceiling tile.</p> <p>— Windows D-2, D-3, D-4, D-5 and D-6 components are the same as Window D-1.</p> <p>— Window C-2 components are the same as Window C-1.</p>							

# LEAD BASED PAINT TESTING DATA SHEET



**Clay Point Associates, Inc.**  
P.O. Box 1254, Williston, VT 05495  
(802) 879-2600

ADDRESS: 82 Craftsbury Road, Greensboro, Vermont Greensboro Town Offices

DATE: January 16, 2024

XRF SERIAL NO.: 2074

ROOM EQUIVALENT: 12

INSPECTOR: Christer Herrmans

READING	COMPONENT	COLOR	SUBSTRATE	COND.	TEST LOCATION/DESCRIPTION	XRF READING (mg/sq. cm)	CLASS
132	Ceiling	White	Metal	Deter.		0.5	Neg.
133	Door	Grey	Wood	Intact	Wall B, Door 1 (Bottom of Stairs)	0.1	Neg.
134	Door Casing	Grey	Wood	Intact	Wall B, Door 1 (Bottom of Stairs)	0.1	Neg.
135	Door Jamb	White	Metal	Intact	Wall B, Door 1 (Bottom of Stairs)	0.0	Neg.
136	Door	Grey	Metal	Intact	Wall D, Door 1 (Middle Landing, to Exterior)	0.1	Neg.
137	Door Casing	Grey	Wood	Intact	Wall D, Door 1 (Middle Landing, to Exterior)	0.1	Neg.
138	Door Jamb	Grey	Wood	Intact	Wall D, Door 1 (Middle Landing, to Exterior)	0.1	Neg.
139	Baluster	Stained	Wood	Intact	Assoc. w/ Stairs	0.0	Neg.
140	Tread	Stained	Wood	Intact	2 <sup>nd</sup> Tread from Bottom	0.1	Neg.
141	Riser	Stained	Wood	Intact	2 <sup>nd</sup> Riser from Bottom	0.1	Neg.
142	Handrail	Stained	Wood	Intact	Assoc. w/ Stairs	0.0	Neg.
143	Vertical Support	Stained	Wood	Intact	Assoc. w/ Handrail	0.0	Neg.
144	Floor	Stained	Wood	Intact	Middle Landing	0.0	Neg.
145	Wall	White	Metal	Deter.	Wall A (upper)	0.3	Neg.
146	Wall	White	Metal	Deter.	Wall B (upper)	0.3	Neg.
147	Wall	White	Metal	Deter.	Wall C (upper)	0.3	Neg.
148	Wall	White	Metal	Deter.	Wall D (upper)	0.3	Neg.
149	Wall	Grey	Wainscoting	Intact	Wall A (lower)	0.1	Neg.
150	Wall	Grey	Wainscoting	Intact	Wall B (lower)	0.1	Neg.
151	Wall	Grey	Wainscoting	Intact	Wall C (lower)	0.1	Neg.

# LEAD BASED PAINT TESTING DATA SHEET



**Clay Point Associates, Inc.**  
P.O. Box 1254, Williston, VT 05495  
(802) 879-2600

ADDRESS: 82 Craftsbury Road, Greensboro, Vermont      Greensboro Town Offices

DATE: January 16, 2024

XRF SERIAL NO.: 2074

ROOM EQUIVALENT: 12 (cont.)

INSPECTOR: Christer Herrmans

READING	COMPONENT	COLOR	SUBSTRATE	COND.	TEST LOCATION/DESCRIPTION	XRF READING (mg/sq. cm)	CLASS
152	Wall	Grey	Wainscoting	Intact	Wall D (lower)	0.1	Neg.
153	½ Wall Cap	Grey	Wood	Deter.	Between Staircases	0.2	Neg.
154	Tread	Stained	Wood	Intact	2 <sup>nd</sup> Tread up from Middle Landing	0.1	Neg.
155	Riser	Stained	Wood	Intact	2 <sup>nd</sup> Riser up from Middle Landing	0.1	Neg.
156	Stringer	Grey	Wood	Intact	Wall C	0.1	Neg.

- Middle Landing Door D-2 components are the same as Middle Landing Door D-1 (double door).
- Bottom landing is vinyl floor tile.

# LEAD BASED PAINT TESTING DATA SHEET



**Clay Point Associates, Inc.**  
P.O. Box 1254, Williston, VT 05495  
(802) 879-2600

ADDRESS: 82 Craftsbury Road, Greensboro, Vermont Greensboro Town Offices

DATE: January 16, 2024

XRF SERIAL NO.: 2074

ROOM EQUIVALENT: 13

INSPECTOR: Christer Herrmans

READING	COMPONENT	COLOR	SUBSTRATE	COND.	TEST LOCATION/DESCRIPTION	XRF READING (mg/sq. cm)	CLASS
157	Ceiling	White	Sheet Rock	Intact		0.0	Neg.
158	Door	Grey	Metal	Intact	Wall D, Door 1	0.1	Neg.
159	Door Casing	Grey	Metal	Intact	Wall D, Door 1	0.0	Neg.
160	Wall	White	Concrete	Intact	Wall A	0.0	Neg.
161	Wall	White	Concrete	Intact	Wall B	0.0	Neg.
162	Wall	White	Wood	Intact	Wall C	0.0	Neg.
163	Wall	White	Concrete	Intact	Wall D	0.0	Neg.
164	Support Column	White	Metal	Intact	Wall C	0.6	Neg.
165	Floor	Green	Concrete	Intact		0.1	Neg.

# LEAD BASED PAINT TESTING DATA SHEET



**Clay Point Associates, Inc.**  
P.O. Box 1254, Williston, VT 05495  
(802) 879-2600

ADDRESS: 82 Craftsbury Road, Greensboro, Vermont Greensboro Town Offices

DATE: January 16, 2024

XRF SERIAL NO.: 2074

ROOM EQUIVALENT: 14

INSPECTOR: Christer Herrmans

READING	COMPONENT	COLOR	SUBSTRATE	COND.	TEST LOCATION/DESCRIPTION	XRF READING (mg/sq. cm)	CLASS
166	Ceiling	Yellow	Metal	Intact		0.2	Neg.
167	Trim	Green	Metal	Intact	Assoc. w/ Ceiling	0.8	Neg.
168	Door	Stained	Wood	Intact	Wall A, Door 1	0.1	Neg.
169	Door Casing	Grey	Metal	Intact	Wall A, Door 1 (inner)	0.0	Neg.
170	Door Casing	Stained	Wood	Intact	Wall A, Door 1 (outer)	0.0	Neg.
171	Door	Stained	Wood	Intact	Wall D, Door 1	0.1	Neg.
172	Door Casing	Stained	Wood	Intact	Wall D, Door 1	0.1	Neg.
173	Door Jamb	Stained	Wood	Intact	Wall D, Door 1	0.1	Neg.
174	Door	Blue	Wood	Intact	Wall B, Door 1	0.0	Neg.
175	Door Casing	Blue	Wood	Intact	Wall B, Door 1	0.1	Neg.
176	Door Jamb	Blue	Wood	Intact	Wall B, Door 1	0.1	Neg.
177	Door	White	Fiberglass	Intact	Wall B, Door 2	0.0	Neg.
178	Door Casing	Stained	Wood	Deter.	Wall B, Door 2	0.0	Neg.
179	Door Stop	Brown	Wood	Deter.	Wall B, Door 2	6.6	<b>POS.</b>
180	Door	Grey	Wood	Deter.	Above Door A-1 (to CPAI Area #19)	0.1	Neg.
181	Door Casing	Grey	Wood	Deter.	Above Door A-1 (to CPAI Area #19)	0.2	Neg.
182	Door Jamb	Grey	Wood	Deter.	Above Door A-1 (to CPAI Area #19)	0.2	Neg.
183	Window Sill	Stained	Wood	Intact	Wall D, Window 5	0.0	Neg.
184	Window Apron	Stained	Wood	Intact	Wall D, Window 5	0.1	Neg.
185	Window Casing	Stained	Wood	Intact	Wall D, Window 5	0.0	Neg.



# LEAD BASED PAINT TESTING DATA SHEET



**Clay Point Associates, Inc.**  
P.O. Box 1254, Williston, VT 05495  
(802) 879-2600

ADDRESS: 82 Craftsbury Road, Greensboro, Vermont Greensboro Town Offices

DATE: January 16, 2024

XRF SERIAL NO.: 2074

ROOM EQUIVALENT: 14 (cont.)

INSPECTOR: Christer Herrmans

READING	COMPONENT	COLOR	SUBSTRATE	COND.	TEST LOCATION/DESCRIPTION	XRF READING (mg/sq. cm)	CLASS
186	Window Sash	Stained	Wood	Intact	Wall D, Window 5	0.0	Neg.
187	Window Well	White	Wood	Deter.	Wall D, Window 5	1.0	<b>POS.</b>
188	Wall	Green	Metal	Intact	Wall A	0.1	Neg.
189	Wall	Green	Metal	Intact	Wall B	0.1	Neg.
190	Wall	Green	Metal	Intact	Wall C	0.1	Neg.
191	Wall	Green	Metal	Intact	Wall D	0.1	Neg.
192	Wall	Green	Wood	Intact	Wall A	0.0	Neg.
193	Wall	Green	Wood	Intact	Wall B	0.0	Neg.
194	Wall	Green	Wood	Intact	Wall D	0.0	Neg.
195	Wall	Stained	Wood	Intact	Wall D	0.0	Neg.
196	Wall	Stained	Wainscoting	Intact	Wall A	0.1	Neg.
197	Wall	Stained	Wainscoting	Intact	Wall B	0.1	Neg.
198	Wall	Stained	Wainscoting	Intact	Wall C	0.1	Neg.
199	Wall	Stained	Wainscoting	Intact	Wall D	0.1	Neg.
200	Floor	Stained	Wood	Intact		0.2	Neg.
201	Radiator	Grey	Metal	Intact	Wall C	0.2	Neg.
202	Backboard	White	Wood	Intact	Wall B, Basketball Net	0.1	Neg.

— Windows B-1 through B-8, C-1 through C-8, and D-1 through D-4 components are the same as Window D-5.

**POS.**

— Wall A Opening (to CPAI Area #17) has no painted components.

# LEAD BASED PAINT TESTING DATA SHEET



**Clay Point Associates, Inc.**  
P.O. Box 1254, Williston, VT 05495  
(802) 879-2600

ADDRESS: 82 Craftsbury Road, Greensboro, Vermont Greensboro Town Offices

DATE: January 16, 2024

XRF SERIAL NO.: 2074

ROOM EQUIVALENT: 15

INSPECTOR: Christer Herrmans

READING	COMPONENT	COLOR	SUBSTRATE	COND.	TEST LOCATION/DESCRIPTION	XRF READING (mg/sq. cm)	CLASS
203	Ceiling	White	Metal	Deter.		0.2	Neg.
204	Door	White	Wood	Intact	Wall A, Door 1	0.1	Neg.
205	Door Casing	White	Wood	Intact	Wall A, Door 1	0.0	Neg.
206	Door Stop	White	Wood	Intact	Wall A, Door 1	0.0	Neg.
207	Door	White	Wood	Intact	Wall B, Door 1	0.0	Neg.
208	Door Casing	White	Wood	Intact	Wall B, Door 1	0.0	Neg.
209	Door Stop	White	Wood	Intact	Wall B, Door 1	0.0	Neg.
210	Window Sill	White	Wood	Deter.	Wall D, Window 1	0.0	Neg.
211	Window Apron	White	Wood	Deter.	Wall D, Window 1	0.1	Neg.
212	Window Casing	White	Wood	Deter.	Wall D, Window 1	0.1	Neg.
213	Window Stop	White	Wood	Deter.	Wall D, Window 1	0.0	Neg.
214	Window Sash	Stained	Wood	Intact	Wall D, Window 1	0.0	Neg.
215	Window Well	White	Wood	Deter.	Wall D, Window 1	1.0	<b>POS.</b>
216	Radiator	Grey	Metal	Intact	Wall D	0.1	Neg.
217	Wall	White	Metal	Deter.	Wall A	0.4	Neg.
218	Wall	White	Metal	Deter.	Wall C	0.4	Neg.
219	Wall	White	Metal	Deter.	Wall D	0.4	Neg.
220	Wall	White	Wood	Intact	Wall B	0.1	Neg.
221	Wall	White	Wood	Intact	Wall C	0.1	Neg.
222	Wall	White	Wainscoting	Intact	Wall A	0.1	Neg.

# LEAD BASED PAINT TESTING DATA SHEET



**Clay Point Associates, Inc.**  
P.O. Box 1254, Williston, VT 05495  
(802) 879-2600

ADDRESS: 82 Craftsbury Road, Greensboro, Vermont Greensboro Town Offices

DATE: January 16, 2024

XRF SERIAL NO.: 2074

ROOM EQUIVALENT: 15 (cont.)

INSPECTOR: Christer Herrmans

READING	COMPONENT	COLOR	SUBSTRATE	COND.	TEST LOCATION/DESCRIPTION	XRF READING (mg/sq. cm)	CLASS
223	Wall	White	Wainscoting	Intact	Wall C	0.1	Neg.
224	Wall	White	Wainscoting	Intact	Wall D	0.1	Neg.
225	Shelf	White	Wood	Intact	Wall B	0.0	Neg.
226	Shelf Support	White	Wood	Intact	Wall B	0.0	Neg.
227	Floor	Green	Wood	Intact		0.2	Neg.

- Windows D-2, D-3 and D-4 components are the same as Window D-1.
- Window components not tested are unpainted vinyl.

# LEAD BASED PAINT TESTING DATA SHEET



**Clay Point Associates, Inc.**  
P.O. Box 1254, Williston, VT 05495  
(802) 879-2600

ADDRESS: 82 Craftsbury Road, Greensboro, Vermont Greensboro Town Offices

DATE: January 16, 2024

XRF SERIAL NO.: 2074

ROOM EQUIVALENT: 16

INSPECTOR: Christer Herrmans

READING	COMPONENT	COLOR	SUBSTRATE	COND.	TEST LOCATION/DESCRIPTION	XRF READING (mg/sq. cm)	CLASS
228	Ceiling	White	Metal	Deter.		0.2	Neg.
229	Door	White	Wood	Intact	Wall B, Door 1	0.1	Neg.
230	Door Casing	White	Wood	Intact	Wall B, Door 1	0.1	Neg.
231	Door Stop	White	Wood	Intact	Wall B, Door 1	0.0	Neg.
232	Door	White	Wood	Intact	Wall C, Door 1	0.0	Neg.
233	Door Casing	White	Wood	Intact	Wall C, Door 1	0.2	Neg.
234	Door Jamb	White	Wood	Intact	Wall C, Door 1	0.0	Neg.
235	Window Sill	White	Wood	Deter.	Wall A, Window 1	0.0	Neg.
236	Window Apron	White	Wood	Deter.	Wall A, Window 1	0.0	Neg.
237	Window Casing	White	Wood	Deter.	Wall A, Window 1	0.0	Neg.
238	Window Stop	White	Wood	Deter.	Wall A, Window 1	0.1	Neg.
239	Window Sash	Stained	Wood	Intact	Wall A, Window 1	0.0	Neg.
240	Window Well	White	Wood	Deter.	Wall A, Window 1	15.3	<b>POS.</b>
241	Wall	White	Metal	Intact	Wall A	0.0	Neg.
242	Wall	White	Metal	Intact	Wall B	0.0	Neg.
243	Wall	White	Metal	Intact	Wall C	0.0	Neg.
244	Wall	White	Metal	Intact	Wall D	0.0	Neg.
245	Wall	White	Wainscoting	Intact	Wall A	0.2	Neg.
246	Wall	White	Wainscoting	Intact	Wall B	0.2	Neg.
247	Wall	White	Wainscoting	Intact	Wall C	0.2	Neg.

# LEAD BASED PAINT TESTING DATA SHEET



**Clay Point Associates, Inc.**  
P.O. Box 1254, Williston, VT 05495  
(802) 879-2600

ADDRESS: 82 Craftsbury Road, Greensboro, Vermont      Greensboro Town Offices

DATE: January 16, 2024

XRF SERIAL NO.: 2074

ROOM EQUIVALENT: 16 (cont.)

INSPECTOR: Christer Herrmans

READING	COMPONENT	COLOR	SUBSTRATE	COND.	TEST LOCATION/DESCRIPTION	XRF READING (mg/sq. cm)	CLASS
248	Wall	White	Wainscoting	Intact	Wall D	0.2	Neg.
249	Floor	Green	Wood	Deter.		0.0	Neg.

— Windows A-2, D-1 and D-2 components are the same as Window A-1.

**POS.**

— Window components not tested are unpainted vinyl.

# LEAD BASED PAINT TESTING DATA SHEET



**Clay Point Associates, Inc.**  
P.O. Box 1254, Williston, VT 05495  
(802) 879-2600

ADDRESS: 82 Craftsbury Road, Greensboro, Vermont Greensboro Town Offices

DATE: January 16, 2024

XRF SERIAL NO.: 2074

ROOM EQUIVALENT: 17

INSPECTOR: Christer Herrmans

READING	COMPONENT	COLOR	SUBSTRATE	COND.	TEST LOCATION/DESCRIPTION	XRF READING (mg/sq. cm)	CLASS
250	Ceiling	Yellow	Metal	Intact		0.2	Neg.
251	Trim	Green	Metal	Intact	Assoc. w/ Ceiling	0.8	Neg.
252	Door	Green	Wood	Intact	Wall D, Door 1	0.6	Neg.
253	Door Casing	Green	Wood	Intact	Wall D, Door 1	0.9	Neg.
254	Door Jamb	White	Wood	Intact	Wall D, Door 1	0.1	Neg.
255	Window Sill	Stained	Wood	Intact	Wall A, Window 1	0.0	Neg.
256	Window Casing	Stained	Wood	Intact	Wall A, Window 1	0.0	Neg.
257	Window Stop	Stained	Wood	Intact	Wall A, Window 1	0.0	Neg.
258	Window Sash	Stained	Wood	Intact	Wall A, Window 1	0.1	Neg.
259	Window Well	White	Wood	Intact	Wall A, Window 1	1.0	<b>POS.</b>
260	Wall	Yellow	Metal	Deter.	Wall A	0.4	Neg.
261	Wall	Stained	Wainscoting	Intact	Wall A	0.1	Neg.
262	Wall	Stained	Wainscoting	Intact	Wall B	0.1	Neg.
263	Wall	Stained	Wainscoting	Intact	Wall D	0.1	Neg.
264	Wall	Grey	Metal	Intact	Wall B	0.0	Neg.
265	Wall	Grey	Metal	Intact	Wall D	0.0	Neg.
266	Wall	Grey	Wood	Intact	Wall B	0.0	Neg.
267	Wall	Grey	Wood	Intact	Wall D	0.0	Neg.
268	Floor	Stained	Wood	Intact		0.0	Neg.

INSPECTOR: Christer Herrmans

READING	COMPONENT	COLOR	SUBSTRATE	COND.	TEST LOCATION/DESCRIPTION	XRF READING (mg/sq. cm)	CLASS
<ul style="list-style-type: none"> <li>— Door B-1 components are the same as Door D-1.</li> </ul>							
<ul style="list-style-type: none"> <li>— Windows A-2, A-3 and A-4 components are the same as Window A-1.</li> </ul>							
<ul style="list-style-type: none"> <li>— Window components not tested are unpainted vinyl.</li> </ul>							
<ul style="list-style-type: none"> <li>— Wall C Opening has no painted components.</li> </ul>							

# LEAD BASED PAINT TESTING DATA SHEET



**Clay Point Associates, Inc.**  
P.O. Box 1254, Williston, VT 05495  
(802) 879-2600

ADDRESS: 82 Craftsbury Road, Greensboro, Vermont Greensboro Town Offices

DATE: January 16, 2024

XRF SERIAL NO.: 2074

ROOM EQUIVALENT: 18

INSPECTOR: Christer Herrmans

READING	COMPONENT	COLOR	SUBSTRATE	COND.	TEST LOCATION/DESCRIPTION	XRF READING (mg/sq. cm)	CLASS
269	Ceiling	White	Metal	Deter.		0.2	Neg.
270	Door	Blue	Wood	Intact	Wall D, Door 1	0.1	Neg.
271	Door Casing	Blue	Wood	Intact	Wall D, Door 1	0.1	Neg.
272	Door Stop	Blue	Wood	Intact	Wall D, Door 1	0.0	Neg.
273	Door	Blue	Wood	Intact	Wall D, Door 2	0.1	Neg.
274	Door Casing	Blue	Wood	Intact	Wall D, Door 2	0.0	Neg.
275	Door Stop	Blue	Wood	Intact	Wall D, Door 2	0.0	Neg.
276	Window Sill	Blue	Wood	Deter.	Wall A, Window 1	0.1	Neg.
277	Window Apron	Blue	Wood	Deter.	Wall A, Window 1	0.0	Neg.
278	Window Casing	Blue	Wood	Deter.	Wall A, Window 1	0.0	Neg.
279	Window Stop	Blue	Wood	Deter.	Wall A, Window 1	0.0	Neg.
280	Window Sash	Stained	Wood	Intact	Wall A, Window 1	0.1	Neg.
281	Window Well	White	Wood	Deter.	Wall A, Window 1	1.5	<b>POS.</b>
282	Wall	Blue	Wood	Intact	Wall C	0.0	Neg.
283	Wall	Blue	Wood	Intact	Wall D	0.0	Neg.
284	Wall	Blue	Wainscoting	Intact	Wall A	0.0	Neg.
285	Wall	Blue	Wainscoting	Intact	Wall B	0.0	Neg.
286	Wall	Blue	Metal	Intact	Wall A	0.0	Neg.
287	Wall	Blue	Metal	Intact	Wall B	0.0	Neg.
288	Floor	Stained	Wood	Intact		0.0	Neg.



INSPECTOR: Christer Herrmans

READING	COMPONENT	COLOR	SUBSTRATE	COND.	TEST LOCATION/DESCRIPTION	XRF READING (mg/sq. cm)	CLASS
<p>— Windows A-2, B-1, B-2, B-3 and B-4 components are the same as Window A-1.</p> <p>— Window components not tested are unpainted vinyl.</p>							POS.

# LEAD BASED PAINT TESTING DATA SHEET



**Clay Point Associates, Inc.**  
P.O. Box 1254, Williston, VT 05495  
(802) 879-2600

ADDRESS: 82 Craftsbury Road, Greensboro, Vermont      Greensboro Town Offices

DATE: January 16, 2024

XRF SERIAL NO.: 2074

ROOM EQUIVALENT: 19

INSPECTOR: Christer Herrmans

READING	COMPONENT	COLOR	SUBSTRATE	COND.	TEST LOCATION/DESCRIPTION	XRF READING (mg/sq. cm)	CLASS
289	Ceiling	Yellow	Metal	Intact		0.2	Neg.
290	Trim	Green	Metal	Intact	Assoc. w/ Ceiling	0.8	Neg.
291	Wall	Yellow	Metal	Intact	Wall D	0.0	Neg.

— All other components are unpainted wood.

# LEAD BASED PAINT TESTING DATA SHEET



**Clay Point Associates, Inc.**  
P.O. Box 1254, Williston, VT 05495  
(802) 879-2600

ADDRESS: 82 Craftsbury Road, Greensboro, Vermont Greensboro Town Offices

DATE: January 16, 2024

XRF SERIAL NO.: 2074

ROOM EQUIVALENT: Exterior Wall A

INSPECTOR: Christer Herrmans

READING	COMPONENT	COLOR	SUBSTRATE	COND.	TEST LOCATION/DESCRIPTION	XRF READING (mg/sq. cm)	CLASS
292	Door	Black	Metal	Intact	Wall A, Door 1	0.0	Neg.
293	Door Casing	Black	Metal	Intact	Wall A, Door 1	0.0	Neg.
294	Door Casing	White	Wood	Intact	Wall A, Door 1	0.0	Neg.
295	Window Casing	White	Wood	Intact	Wall A, Window 1 (1 <sup>st</sup> Floor)	0.1	Neg.
296	Window Sash	White	Wood	Intact	Wall A, Window 1 (1 <sup>st</sup> Floor)	0.0	Neg.
297	Window Sill	White	Wood	Deter.	Wall A, Window 1 (2 <sup>nd</sup> Floor)	23.5	<b>POS.</b>
298	Window Casing	White	Wood	Deter.	Wall A, Window 1 (2 <sup>nd</sup> Floor)	15.0	<b>POS.</b>
299	Window Sash	White	Wood	Intact	Wall A, Window 1 (2 <sup>nd</sup> Floor)	0.1	Neg.
300	Siding	Black	Wood	Deter.	Wall A (upper)	28.2	<b>POS.</b>
301	Siding	Grey	Wood	Deter.	Wall A (lower)	20.3	<b>POS.</b>
302	Skirtboard	White	Wood	Deter.	Wall A	23.2	<b>POS.</b>
303	Foundation	Grey	Wood	Intact	Wall A	0.1	Neg.
304	Soffit	White	Wood	Intact	Assoc. w/ Overhang	0.0	Neg.
305	Fascia	White	Wood	Intact	Assoc. w/ Overhang	0.0	Neg.
306	Deck	White	Wood	Intact	Assoc. w/ Overhang	0.0	Neg.
307	Horizontal Board	White	Wood	Intact	Assoc. w/ Overhang	0.0	Neg.
308	Diagonal Support	White	Wood	Intact	Assoc. w/ Overhang	0.0	Neg.
309	Siding	Grey	Wood	Intact	Assoc. w/ Overhang	0.0	Neg.
310	Corner Board	White	Wood	Intact	Wall A/Wall B	22.0	<b>POS.</b>
311	Corner Board	White	Wood	Intact	Wall A/ Wall D	21.0	<b>POS.</b>

INSPECTOR: Christer Herrmans

READING	COMPONENT	COLOR	SUBSTRATE	COND.	TEST LOCATION/DESCRIPTION	XRF READING (mg/sq. cm)	CLASS
— Upper Soffit and Fascia are inaccessible.							<b>POS.</b>
— Basement Window A-2 components are the same as Basement Window A-1.							
— All 2 <sup>nd</sup> and 3 <sup>rd</sup> Floor Window components are the same as 2 <sup>nd</sup> Floor Window A-1.							<b>POS.</b>

# LEAD BASED PAINT TESTING DATA SHEET



**Clay Point Associates, Inc.**  
P.O. Box 1254, Williston, VT 05495  
(802) 879-2600

ADDRESS: 82 Craftsbury Road, Greensboro, Vermont Greensboro Town Offices

DATE: January 16, 2024

XRF SERIAL NO.: 2074

ROOM EQUIVALENT: Exterior Wall B

INSPECTOR: Christer Herrmans

READING	COMPONENT	COLOR	SUBSTRATE	COND.	TEST LOCATION/DESCRIPTION	XRF READING (mg/sq. cm)	CLASS
312	Door	Grey	Fiberglass	Intact	Wall B, Door 1 (3 <sup>rd</sup> Floor)	0.0	Neg.
313	Door Casing	White	Wood	Intact	Wall B, Door 1 (3 <sup>rd</sup> Floor)	1.0	<b>POS.</b>
314	Door Jamb	White	Wood	Intact	Wall B, Door 1 (3 <sup>rd</sup> Floor)	1.2	<b>POS.</b>
315	Door	Grey	Wood	Intact	Wall B, Door 1 (2 <sup>nd</sup> Floor)	0.0	Neg.
316	Door Casing	White	Wood	Intact	Wall B, Door 1 (2 <sup>nd</sup> Floor)	1.2	<b>POS.</b>
317	Door Casing	White	Wood	Intact	Wall B, Door 1 (2 <sup>nd</sup> Floor) (Outer)	14.0	<b>POS.</b>
318	Window Sill	White	Wood	Deter.	Wall B, Window 1 (2 <sup>nd</sup> Floor)	28.2	<b>POS.</b>
319	Window Casing	White	Wood	Deter.	Wall B, Window 1 (2 <sup>nd</sup> Floor)	20.3	<b>POS.</b>
320	Window Sash	White	Wood	Intact	Wall B, Window 1 (2 <sup>nd</sup> Floor)	0.0	Neg.
321	Window Casing	White	Wood	Intact	Wall B, Window 1 (1 <sup>st</sup> Floor)	0.1	Neg.
322	Window Sash	White	Wood	Intact	Wall B, Window 1 (1 <sup>st</sup> Floor)	0.0	Neg.
323	Siding	Black	Wood	Deter.	Wall B	25.2	<b>POS.</b>
324	Siding	Grey	Wood	Deter.	Wall B	22.3	<b>POS.</b>
325	Skirtboard	White	Wood	Deter.	Wall B	21.0	<b>POS.</b>
326	Corner Board	White	Wood	Deter.	Wall B/Wall C	22.1	<b>POS.</b>
327	Corner Board	White	Wood	Deter.	Wall B/Wall A	21.3	<b>POS.</b>

ADDRESS: 82 Craftsbury Road, Greensboro, Vermont      Greensboro Town Offices      DATE: January 16, 2024

XRF SERIAL NO.: 2074      ROOM EQUIVALENT: Exterior Wall B (cont.)      INSPECTOR: Christer Herrmans

Page 32 of 35Inspector's Initials CHA

# LEAD BASED PAINT TESTING DATA SHEET



**Clay Point Associates, Inc.**  
P.O. Box 1254, Williston, VT 05495  
(802) 879-2600

ADDRESS: 82 Craftsbury Road, Greensboro, Vermont Greensboro Town Offices

DATE: January 16, 2024

XRF SERIAL NO.: 2074

ROOM EQUIVALENT: Exterior Wall C

INSPECTOR: Christer Herrmans

READING	COMPONENT	COLOR	SUBSTRATE	COND.	TEST LOCATION/DESCRIPTION	XRF READING (mg/sq. cm)	CLASS
328	Window Casing	White	Wood	Intact	Wall C, Window 1 (1 <sup>st</sup> Floor)	0.1	Neg.
329	Window Sash	White	Wood	Intact	Wall C, Window 1 (1 <sup>st</sup> Floor)	0.0	Neg.
330	Window Sill	White	Wood	Deter.	Wall C, Window 1 (2 <sup>nd</sup> Floor)	23.5	<b>POS.</b>
331	Window Casing	White	Wood	Deter.	Wall C, Window 1 (2 <sup>nd</sup> Floor)	15.0	<b>POS.</b>
332	Window Sash	White	Wood	Intact	Wall C, Window 1 (2 <sup>nd</sup> Floor)	0.1	Neg.
333	Siding	Black	Wood	Intact	Wall C	28.2	<b>POS.</b>
334	Siding	Grey	Wood	Intact	Wall C	20.3	<b>POS.</b>
335	Skirtboard	White	Wood	Intact	Wall C	23.2	<b>POS.</b>
336	Foundation	Grey	Wood	Intact	Wall C	0.0	Neg.
337	Corner Board	White	Wood	Deter.	Wall C/Wall B	22.0	<b>POS.</b>
338	Corner Board	White	Wood	Deter.	Wall C/Wall D	21.0	<b>POS.</b>
— Soffit and Fascia are inaccessible.							<b>POS.</b>
— 1 <sup>st</sup> Floor Windows C-2 and C-3 components are the same as 1 <sup>st</sup> Floor Window C-1.							
— 2 <sup>nd</sup> and 3 <sup>rd</sup> Floor Window components are the same as 2 <sup>nd</sup> Floor Window C-1.							<b>POS.</b>

# LEAD BASED PAINT TESTING DATA SHEET



**Clay Point Associates, Inc.**  
P.O. Box 1254, Williston, VT 05495  
(802) 879-2600

ADDRESS: 82 Craftsbury Road, Greensboro, Vermont Greensboro Town Offices

DATE: January 16, 2024

XRF SERIAL NO.: 2074

ROOM EQUIVALENT: Exterior Wall D

INSPECTOR: Christer Herrmans

READING	COMPONENT	COLOR	SUBSTRATE	COND.	TEST LOCATION/DESCRIPTION	XRF READING (mg/sq. cm)	CLASS
339	Door	Grey	Wood	Intact	Wall D, Door 1 (2 <sup>nd</sup> Floor)	0.0	Neg.
340	Door Casing	White	Wood	Intact	Wall D, Door 1 (2 <sup>nd</sup> Floor)	20.7	<b>POS.</b>
341	Door Jamb	White	Wood	Intact	Wall D, Door 1 (2 <sup>nd</sup> Floor)	20.7	<b>POS.</b>
342	Window Casing	White	Wood	Intact	Above 2 <sup>nd</sup> Floor Door D-1	0.4	Neg.
343	Window Sash	Green	Wood	Intact	Above 2 <sup>nd</sup> Floor Door D-1	21.5	<b>POS.</b>
344	Soffit	White	Wood	Intact	Assoc. w/ Overhang (2 <sup>nd</sup> Floor)	7.1	<b>POS.</b>
345	Fascia	White	Wood	Intact	Assoc. w/ Overhang (2 <sup>nd</sup> Floor)	7.1	<b>POS.</b>
346	Deck	White	Wood	Intact	Assoc. w/ Overhang (2 <sup>nd</sup> Floor)	1.0	<b>POS.</b>
347	Horizontal Board	White	Wood	Intact	Assoc. w/ Overhang (2 <sup>nd</sup> Floor)	10.0	<b>POS.</b>
348	Diagonal Support	White	Wood	Intact	Assoc. w/ Overhang (2 <sup>nd</sup> Floor)	4.4	<b>POS.</b>
349	Window Casing	White	Wood	Intact	Wall D, Window 1 (1 <sup>st</sup> Floor)	0.0	Neg.
350	Window Sash	White	Wood	Intact	Wall D, Window 1 (1 <sup>st</sup> Floor)	0.1	Neg.
351	Window Sill	White	Wood	Deter.	Wall D, Window 12 (2 <sup>nd</sup> Floor)	10.9	<b>POS.</b>
352	Window Casing	White	Wood	Deter.	Wall D, Window 12 (2 <sup>nd</sup> Floor)	15.2	<b>POS.</b>
353	Window Sash	White	Wood	Intact	Wall D, Window 12 (2 <sup>nd</sup> Floor)	0.0	Neg.
354	Siding	Black	Wood	Deter.	Wall D	25.6	<b>POS.</b>
355	Siding	Grey	Wood	Deter.	Wall D	23.2	<b>POS.</b>
356	Skirtboard	White	Wood	Deter.	Wall D	22.3	<b>POS.</b>
357	Corner Board	White	Wood	Deter.	Wall D/Wall C	21.8	<b>POS.</b>
358	Corner Board	White	Wood	Deter.	Wall D/Wall A	20.6	<b>POS.</b>



**Clay Point Associates, Inc.**  
**P.O. Box 1254, Williston, VT 05495**  
**(802) 879-2600**

DATE: January 16, 2024

INSPECTOR: Christer Herrmans

READING	COMPONENT	COLOR	SUBSTRATE	COND.	TEST LOCATION/DESCRIPTION	XRF READING (mg/sq. cm)	CLASS
359	Decorative Trim	White	Wood	Deter.	Wall D, Near Door D-1	10.6	<b>POS.</b>
<p>— Soffit and Fascia are inaccessible. <b>POS.</b></p> <p>— 2<sup>nd</sup> Floor Door D-2 components are the same as 2<sup>nd</sup> Floor Door D-1 (double door). <b>POS.</b></p> <p>— 1<sup>st</sup> Floor Windows D-2 through D-12 components are the same as Basement Window D-1. Neg.</p> <p>— 2<sup>nd</sup> and 3<sup>rd</sup> Floor Window components are the same as 2<sup>nd</sup> Floor Window D-12. <b>POS.</b></p>							

**LEAD CONSULTING ENTITY**

CLAY POINT ASSOCIATES INC  
PO BOX 1254 25 BISHOP AVE STE B-2  
WILLISTON, VT 05495-1254

Vermont Department of Health  
Environmental Health  
P.O. Box 70 - Drawer 30  
Burlington, VT 05402-0070

LICENSE: LC200999

EXPIRES: Saturday, April 27, 2024

CERTIFICATE OF LICENSE  
VERMONT LEAD REGULATORY PROGRAM

THIS CERTIFICATE SHALL REMAIN IN FORCE UNTIL THE EXPIRATION DATE UNLESS REVOKED  
OR VOIDED BEFORE THAT TIME.

THIS CERTIFICATE IS NOT TRANSFERABLE AND IS VALID ONLY FOR THE ABOVE PARTY.

COPY OF THIS CERTIFICATE MUST BE ON SITE AT ALL TIMES.

**LEAD CONSULTING ENTITY**

CLAY POINT ASSOCIATES INC  
PO BOX 1254 25 BISHOP AVE STE B-2  
WILLISTON, VT 05495-1254

Vermont Department of Health  
Environmental Health  
P.O. Box 70 - Drawer 30  
Burlington, VT 05402-0070

LICENSE: LC200999

EXPIRES: Saturday, April 27, 2024

CERTIFICATE OF LICENSE  
VERMONT LEAD REGULATORY PROGRAM

THIS CERTIFICATE SHALL REMAIN IN FORCE UNTIL THE EXPIRATION DATE UNLESS REVOKED  
OR VOIDED BEFORE THAT TIME.

THIS CERTIFICATE IS NOT TRANSFERABLE AND IS VALID ONLY FOR THE ABOVE PARTY.

COPY OF THIS CERTIFICATE MUST BE ON SITE AT ALL TIMES.



Certificate of License - Vermont Asbestos and Lead Regulatory Program

## Lead Inspector & Risk Assessor

**CHRISTER HERRMANS**

LICENSE: Lead-I/RA-000011

EXPIRES: 8/31/2024

This certificate shall remain in force until the expiration date unless revoked or voided before that time. This certificate is not transferable and is valid only for the above party.

A copy of this certificate must be on the work site at all times.



Any lead-based paint consulting activities must be performed in association with a Lead-based Paint Consulting Company licensed pursuant to the Vermont Regulations for Lead Control section 12.10.

Scan the QR Code for License Information

Vermont Department of Health  
Environmental Health  
108 Cherry Street, Suite 201  
Burlington, VT 05402  
[ALRP@vermont.gov](mailto:ALRP@vermont.gov)