

Proposed Boathouse, man property, tax ID 33

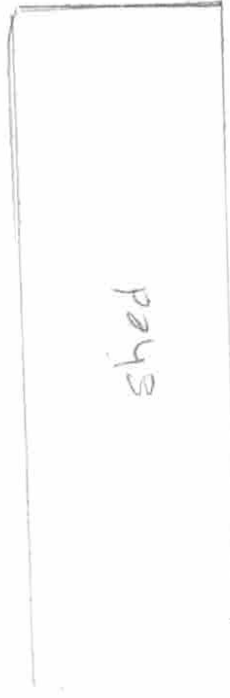

shed

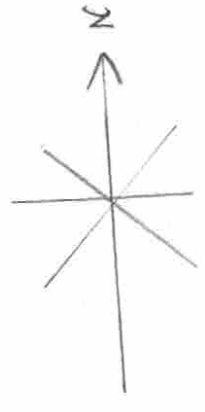

Cottage

Lakeshore Path

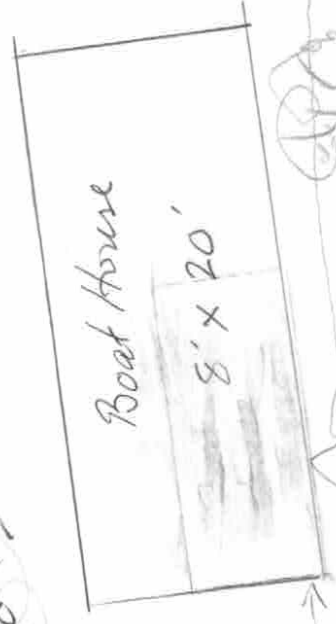

Boat House

8' x 20'

Redirection

29'

6' from bank, 16' from shoreline



Beach

wake

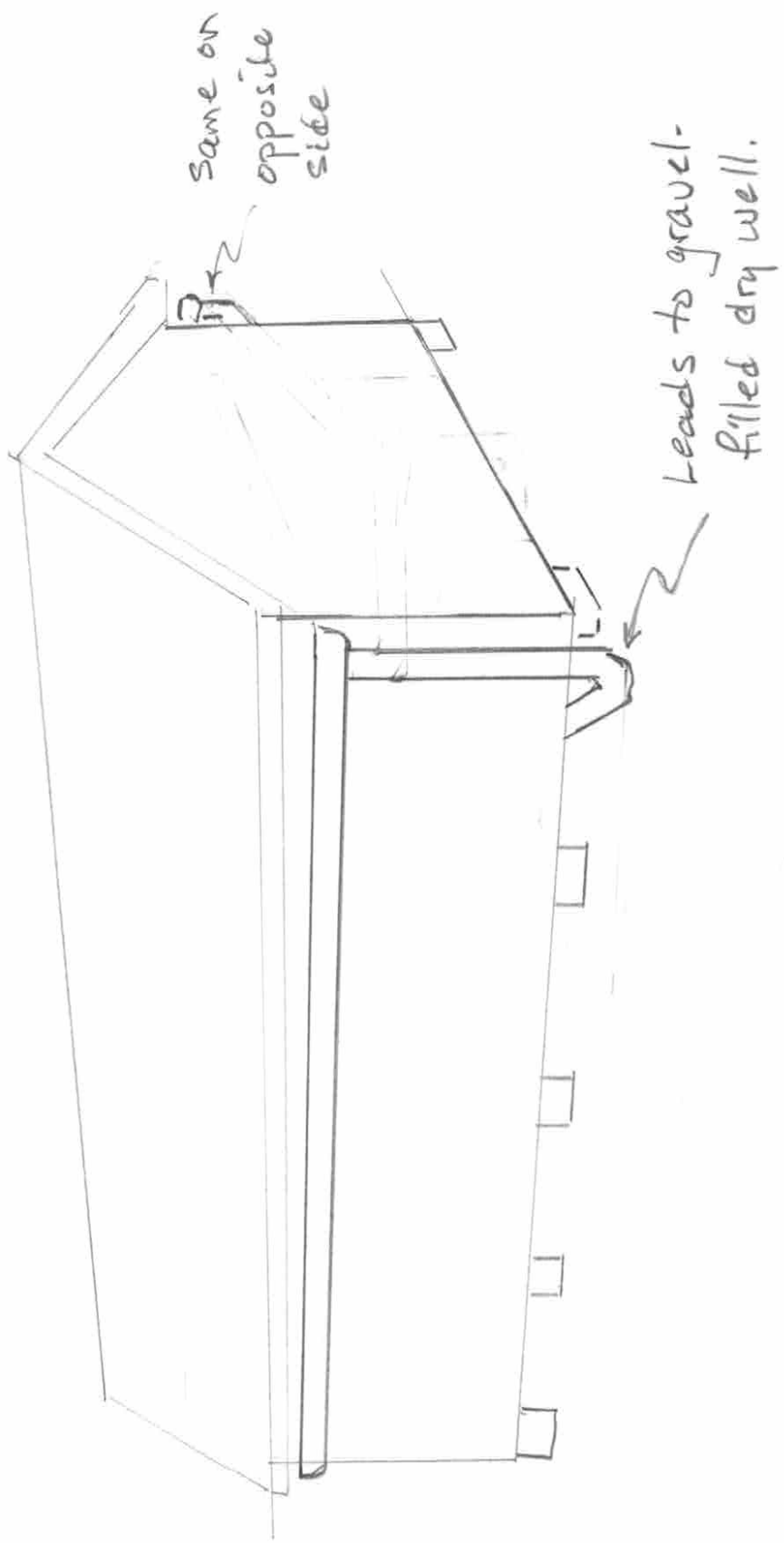

Gutters for Rainwater Retention

side view

Gutters + Downspouts w/ Drywell

end view

← 6' →
(from memory)

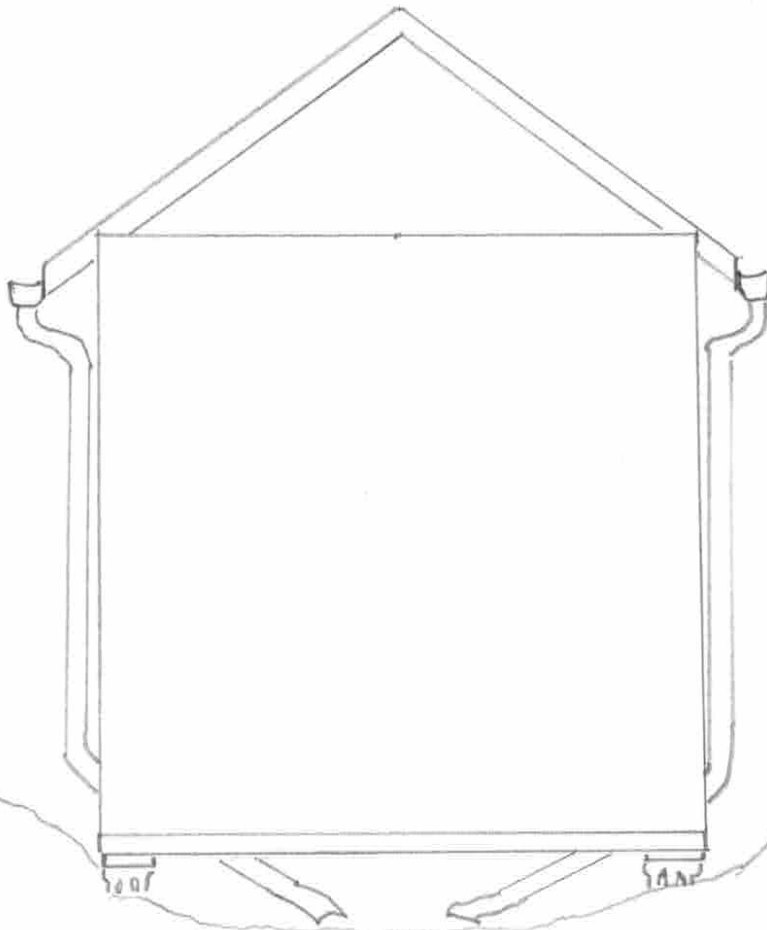

Gravel filled
Dry well
8" deep

Tree Roots on
Rocky Ledge

(2024)
Lake
2-15-
ASD

Gutters and Rainbarrel

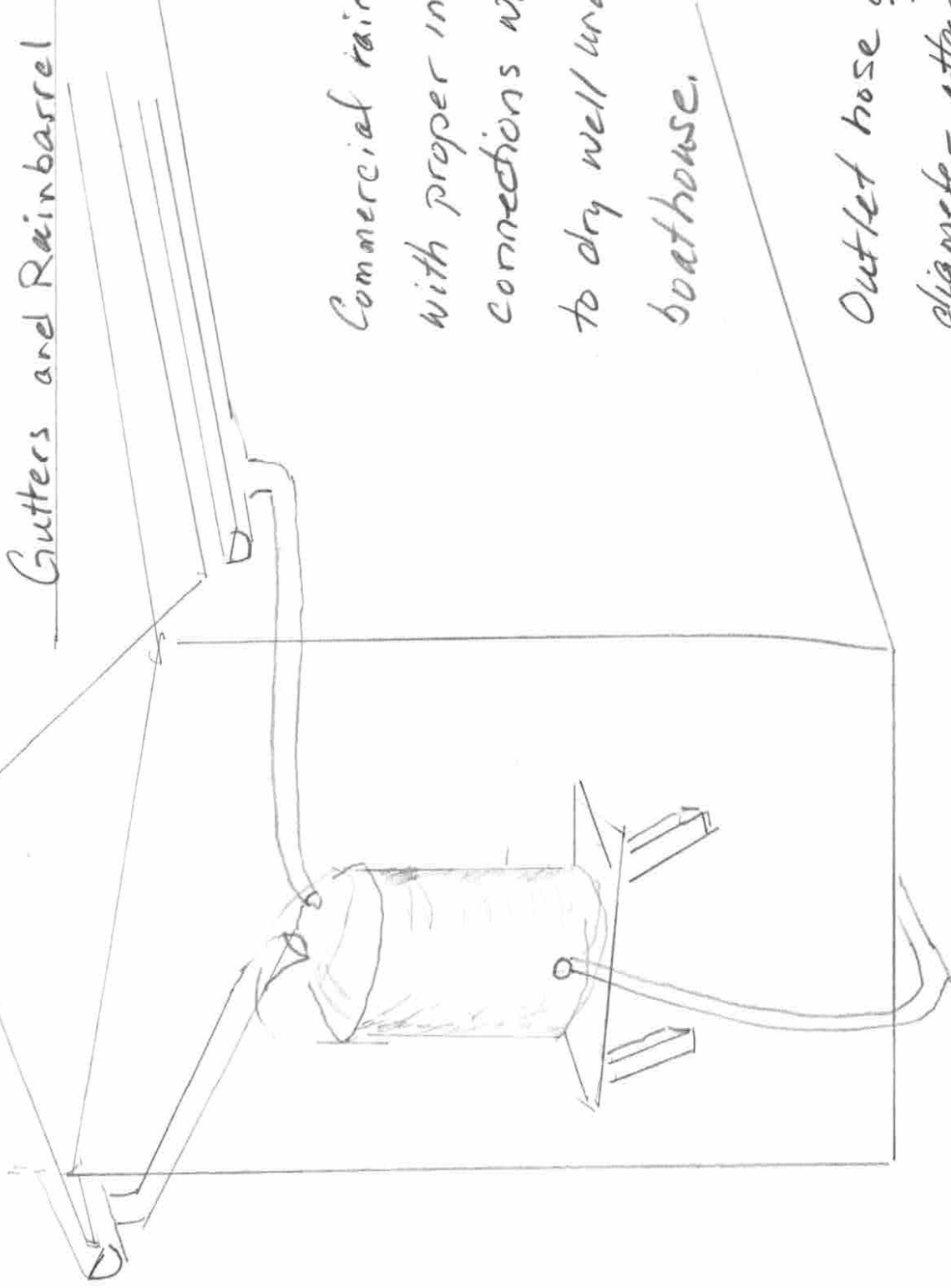

Commercial rain barrel
with proper inlet/outlet
connections would drain
to dry well underneath
boathouse.

Outlet hose of smaller
diameter attached to tap
on sprigot allows slow
release of built-up water.